

EMS Site Map



1st Level: City map



2nd Level: Zoomed in from the city map



3rd Level: Exterior view of the building



4th Level: Detailed floor plan of the building

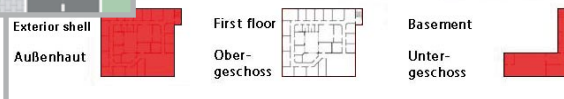

EMS Site Map is a multi-level site plan that allows for targeted access to cameras or transmitters via an interactive, freely configurable GUI (Graphical User Interface). With the ability to select individual remote sites and then select specific cameras based on a "site map" of the customers premises; this is a very powerful add-on especially for operators who don't have an intimate knowledge of the layout of the remotely monitored site.

- Separate software package designed as an extension to the EMS
- The multi-level, interactive layout plan functionality offers intuitive but focused, camera-selective access to the remote video transmitters and their operational control
- The connected video systems can be controlled and recorded images can be accessed individually and directly using the relevant layout plans
- Relay control via on-screen symbols
- Relevant site plan is automatically displayed on receipt of an alarm (no user intervention required)
- Interactive camera symbols indicate which alarm sensor has triggered the alarm (flashing symbol)
- Design mode offers a built-in editor for the configuration of maps (e.g. resizing of the main image, adding/deleting cameras, configuration of relays)
- Existing Maps can be easily imported in the JPEG or bitmap formats
- Optional add-on per workstation (single licenses)

